

---

Operating instructions and spare parts list

# Automatic powder gun OptiGun GA03

CE<sub>0102</sub> Ex II 2D



Translation of the original operating instructions

## **Documentation Automatic powder gun OptiGun GA03**

© Copyright 2012-2021 Gema Switzerland GmbH

All rights reserved.

This publication is protected by copyright. Unauthorized copying is prohibited by law. No part of this publication may be reproduced, photocopied, translated, stored on a retrieval system or transmitted in any form or by any means for any purpose, neither as a whole nor partially, without the express written consent of Gema Switzerland GmbH.

MagicCompact, MagicCylinder, MagicPlus, MagicControl, OptiFlex, OptiControl, OptiGun, OptiSelect, OptiStar and SuperCorona are registered trademarks of Gema Switzerland GmbH.

OptiFlow, OptiCenter, OptiMove, OptiSpeeder, OptiFeed, OptiSpray, OptiSieve, OptiAir, OptiPlus, OptiMaster, MultiTronic, EquiFlow, Precise Charge Control (PCC), Smart Inline Technology (SIT) and Digital Valve Control (DVC) are trademarks of Gema Switzerland GmbH.

All other product names are trademarks or registered trademarks of their respective holders.

Reference is made in this manual to different trademarks or registered trademarks. Such references do not mean that the manufacturers concerned approve of or are bound in any form by this manual. We have endeavored to retain the preferred spelling of the trademarks, and registered trademarks of the copyright holders.

To the best of our knowledge and belief, the information contained in this publication was correct and valid on the date of publication. Gema Switzerland GmbH makes no representations or warranties with respect to the contents or use of this publication, and reserves the right to revise this publication and make changes to its content without prior notice.

For the latest information about Gema products, visit [www.gemapowdercoating.com](http://www.gemapowdercoating.com).

For information regarding patents, visit [www.gemapowdercoating.com/patents](http://www.gemapowdercoating.com/patents) or [www.gemapowdercoating.us/patents](http://www.gemapowdercoating.us/patents).

### **Printed in Switzerland**

Gema Switzerland GmbH  
Mövenstrasse 17  
9015 St.Gallen  
Switzerland

Phone: +41-71-313 83 00

Fax: +41-71-313 83 83

E-mail: [info@gema.eu.com](mailto:info@gema.eu.com)

# Table of contents

<b>About this instructions</b>	<b>3</b>
General information .....	3
Keeping the manual .....	3
Safety symbols (pictograms).....	3
Presentation of the contents .....	4
Figure references in the text .....	4
<b>Safety</b>	<b>5</b>
General information .....	5
Intended use .....	5
Product specific safety information .....	6
<b>Product description</b>	<b>7</b>
Field of application .....	7
Utilization.....	7
Reasonably foreseeable misuse.....	7
Technical Data .....	8
Electrical data.....	8
Dimensions .....	8
Processible powders .....	8
Design and function .....	9
Scope of delivery.....	9
Available accessories .....	9
SuperCorona ring.....	10
Principle of operation .....	12
High voltage generation .....	12
Circuit .....	12
Powder flow and electrode rinsing air .....	12
Spray nozzle .....	13
Typical characteristics – properties of the functions .....	14
Powder hose quick release connection .....	14
Connection for SuperCorona Ring.....	14
<b>Start-up</b>	<b>15</b>
Preparation for start-up .....	15
Basic conditions .....	15
Connect the OptiGun automatic powder gun.....	15
<b>Initial start-up</b>	<b>17</b>
Operation .....	18
Setting of total air .....	18
Setting the powder quantity .....	19
Setting the electrode rinsing air .....	19
Functional check .....	20
General information .....	20
Troubleshooting .....	20

Start-up and powder coating .....	21
Shut-down.....	21
<b>Cleaning and maintenance</b>	<b>23</b>
General information .....	23
Cleaning.....	23
Gun cleaning .....	23
Cleaning the spray nozzle .....	24
Maintenance .....	24
Replacing parts.....	25
Dismantling the gun.....	25
General information .....	25
Dismantling procedure.....	26
Assembling the powder gun .....	31
Repairing the powder gun .....	31
Powder hose quick release connection.....	32
<b>Troubleshooting</b>	<b>33</b>
<b>Spare parts list</b>	<b>35</b>
Ordering spare parts.....	35
OptiGun GA03 – complete .....	36
OptiGun GA03 – gun body .....	37
OptiGun GA03 – shaft .....	38
OptiGun GA03-X – complete.....	39
OptiGun GA03-X – Extension tube .....	40
OptiGun GA03-X – options when using several powder hoses .....	41
Gun cable .....	42
OptiGun GA03 – SuperCorona.....	43
OptiGun GA03 – angled nozzles .....	44
OptiGun GA03 – accessories .....	45
Flat jet nozzles – overview (wearing parts) .....	45
Round jet nozzles – overview (wearing parts).....	46
Gun extensions.....	47
Spray nozzles for extensions – overview (wearing parts) .....	48
Powder hoses – overview.....	49

# About this instructions

---

## General information

This operating manual contains all the important information you require for the working with the OptiGun GA03 Automatic powder gun. It will safely guide you through the start-up process and give you references and tips for the optimal use of your new powder coating system.

Information about the functional mode of the individual system components should be referenced in the respective enclosed documents.

---

## Keeping the manual

Please keep this Manual ready for later use or if there should be any queries.

---

## Safety symbols (pictograms)

The following contains a list of warnings with their meanings found in the Gema operating instructions. Apart from the regulations in the relevant operating instructions, the general safety precautions must also be followed .

### DANGER

Indicates a hazardous situation which, if not avoided, will result in death or serious injury.

### WARNING

Indicates a potentially hazardous situation which, if not avoided, could result in death or serious injury.

### CAUTION

Indicates a potentially hazardous situation which, if not avoided, could result in minor or moderate injury.

**ATTENTION**

Indicates a potentially harmful situation which, if not avoided, the equipment or something in its surrounding may be damaged.

---

**ENVIRONMENT**

Indicates a potentially harmful situation which, if not avoided, may have harmful consequences for the environment.

---

**NOTE**

Useful tips and other information.

---

---

## Presentation of the contents

### Figure references in the text

Figure references are used as cross references in the descriptive text.

**Example:**

"The high voltage (**H**) created in the gun cascade is guided through the center electrode.

# Safety

---

## General information

This chapter sets out the fundamental safety regulations, that must be followed by the user and third parties using the powder gun.

These safety regulations must be read and understood before the gun is put into operation.

### **WARNING**

#### **Working without operating instructions**

**Working without operating instructions or with individual pages from the operating instructions may result in damage to property and personal injury if relevant safety information is not observed.**

- Before working with the device, organize the required documents and read the section on "Safety regulations".
  - Work should only be carried out in accordance with the instructions in the relevant documents.
  - Always work with the complete original document.
- 

---

## Intended use

- This product is built to the latest specification and conforms to the recognized technical safety regulations and is designed for the normal application of powder coating.
- Any other use is considered non-compliant. The manufacturer is not responsible for any incorrect use and the risks associated with such actions are assumed by the user alone. If this product is to be used for other purposes or other substances outside of our guidelines then Gema Switzerland GmbH should be consulted.
- Observance of the operating, service and maintenance instructions specified by the manufacturer is also part of conformity of use. This product should only be used, maintained and started up by trained personnel, who are informed about and are familiar with the possible hazards involved.
- Start-up (i.e. the execution of intended operational tasks) is forbidden until it has been established that this product has been set up and wired according to the guidelines for machinery. The standard "Machine safety" must also be observed.

- Unauthorized modifications to the product exempt the manufacturer from any liability from resulting damage.
- The relevant accident prevention regulations, as well as other generally recognized safety regulations, occupational health and structural regulations are to be observed.
- Furthermore, the country-specific safety regulations also must be observed.

Explosion protection	Protection type	Temperature class
CE <sub>0102</sub>  II 2D	IP64	T6 (zone 21) T4 (zone 22)

---

## Product specific safety information

- This product is a constituent part of the equipment and is therefore integrated in the system's safety concept.
- If it is to be used in a manner outside the scope of the safety concept, then corresponding measures must be taken.
- The installation work to be done by the customer must be carried out according to local regulations.
- It must be ensured, that all components are earthed according to the local regulations before start-up.



---

### NOTE

For further security information, see the detailed Gema safety .

---



# Product description

---

## Field of application

The OptiGun GA03 Automatic powder gun is built exclusively for the electrostatic coating with organic powders. Any other use is considered non-compliant. The manufacturer shall not be liable for damage resulting from such use; the user bears sole responsibility for such actions.



*fig. 1: OptiGun GA03 automatic powder gun*

## Utilization



The Automatic gun type OptiGun GA03 is suited for the electrostatic coating of objects (in all shapes and geometries) that must be grounded.

## Reasonably foreseeable misuse

- Coating of non grounded objects
- Use of enameled powder
- Incorrectly configured values for powder conveyance
- Incorrectly configured values for electrode rinsing air
- Use of moist powder

## Technical Data

### Electrical data

OptiGun GA03	
Nominal input voltage	12 V
Frequency	18 kHz (average)
Nominal output voltage	100 kV
Polarity	negative (optional positive)
Max. output current	100 µA
Ignition protection	Type A acc. EN 50177 Ex 2 mJ T6
Temperature range	0 °C - +40 °C (+32 °F - +104 °F)
Max. surface temperature	85 °C (+185 °F)
Protection type	IP64
Approvals	 0102  II 2D PTB 11 ATEX 5006-1

### Dimensions

OptiGun GA03	
Weight	600 g

### Processible powders

OptiGun GA03	
Plastic powder	yes
Metallic powder	yes
Enamel powder	no

### ATTENTION

The OptiGun GA03 Automatic powder gun may only be connected to the following control units:

- OptiStar CG06, CG07, CG08, CG09, CG10, CG12, CG13 and MultiStar CG10!

## Design and function

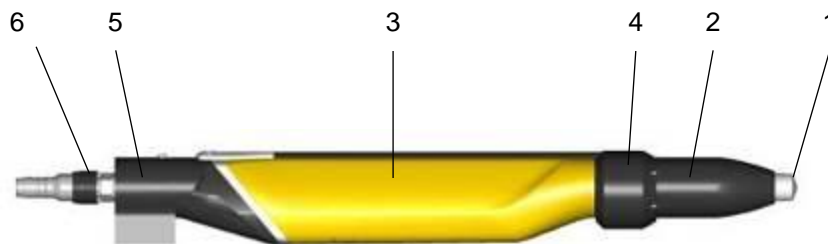

fig. 2: Structure

- |   |   |   |                  |
|---|---|---|------------------|
| 1 | Spray nozzle                              | 4 | SuperCorona ring |
| 2 | Threaded sleeve                           | 5 | Gun fixture      |
| 3 | Shaft with removable high voltage cascade | 6 | Clamp ring       |

## Scope of delivery

- OptiGun GA03 Automatic powder gun with gun cable (20 m)\*, negative polarity
- Electrode rinsing air hose (20 m)\*
- Flat jet nozzle NF27, complete (incl. electrode holder)
- Cable tie with Velcro closure
- Gun cleaning brush
- Spare parts kit
- Operating manual

\* standard

### Available accessories

- SuperCorona ring
- Flat jet nozzle (for specific applications)
- Round jet nozzles
- Gun extension 150 and 300 mm
- Angled nozzles 45°, 60° and 90°
- Gun cable extensions
- Powder tube extensions (when using several powder hoses)

For more information, see spare parts list!

## SuperCorona ring

### *Field of application*

The SuperCorona is an optional extension for the OptiGun GA03 Automatic powder gun, allowing for a better surface quality when coating with the powder coating equipment.

When coating wheel rims, drawers, radiators, lamps etc. the surface quality is exceptional, also in places with higher coating layer requirements. By coating with several powder types, an "orange peel" finish can be completely avoided. By coating with structure powder, the "picture frame effect" is hardly visible.

The performance of the OptiGun with SuperCorona is convincing due to its very good charging and very high deposition rate as well as an improved penetration into Faraday cages. The distance between nozzle and workpiece can be reduced to 100 mm without influencing the surface finish.



*fig. 3: SuperCorona – retrofit*

Due to its modular structure, the OptiGun Automatic powder gun can be extended quickly and easily with the lightweight SuperCorona (approx. 75 g). The OptiGun remains repair-friendly and easy to maintain even after reconfiguration.

***SuperCorona assembly***

Before fitting the SuperCorona ring, make sure that the connection and the plug-in connector are free from grease and powder, otherwise the electric contact cannot be guaranteed.

1.



2.

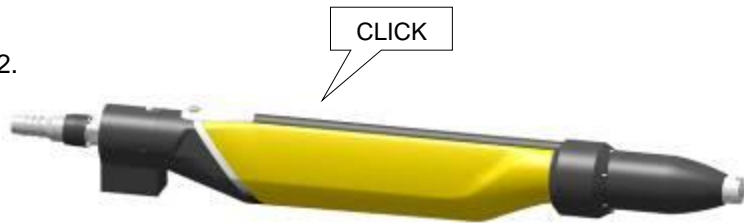

## Principle of operation

### High voltage generation

The control unit supplies a high-frequency low voltage signal of approx. 12 V eff. This voltage is fed through the gun cable (11) and the gun plug to the high voltage cascade (4) in the gun body.

In the high voltage cascade (2), the low voltage is high-transformed in a first step (c). This primary high voltage is subsequently rectified and multiplied in the high voltage cascade in a second step (d), until the required high voltage is obtained at the end (approx. 100 kV). The high voltage is now fed to the electrode (e) within the spray nozzle.

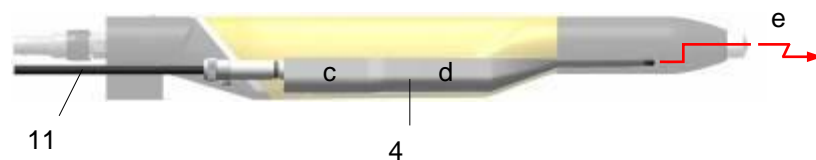

fig. 4: High voltage generation

### Circuit

The OptiGun Automatic powder gun is switched on and off by the gun control module.

The control unit allows also the adjustment of low voltage, powder flow and electrode rinsing air to the gun.

### Powder flow and electrode rinsing air

The electrode rinsing air is used by vented spray nozzles and is connected with its designated connection on the rear side of the gun control unit (see the operating manual of the gun control unit).

The functions of the spray nozzles are described in the following sections.

## Spray nozzle

### ***Flat jet nozzle with vented central electrode***

The vented flat jet nozzle serves for the spraying and the charging of the powder. The powder is charged by the central electrode (E). The high voltage (H) created in the gun cascade is guided through the center electrode.

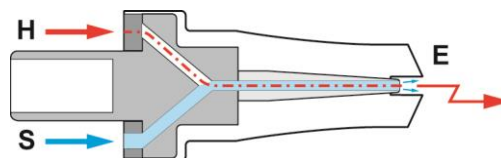

*fig. 5: Flat jet nozzle with vented central electrode*

In order to prevent powder from sintering on the electrode, compressed air is used during the spray process.

The electrode rinsing air (S) adjustment on the gun control unit is described in the corresponding operating manual.

### ***Round jet nozzle with vented deflector and vented central electrode***

The vented deflector is used, to give the powder stream emerging from the gun, a cloud formation. The powder is charged by the central electrode (E). The high voltage (H) created in the gun cascade is guided through the center electrode.

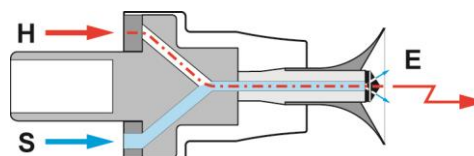

*fig. 6: Round jet nozzle with vented deflector and vented central electrode*

Since powder can accumulate on the baffle plate, it must be rinsed with compressed air.

The electrode rinsing air (S) adjustment on the gun control unit is described in the corresponding operating manual.

---

## Typical characteristics – properties of the functions

- Continuous, tightly sealed gun body with separate channels for cascade and electrode rinsing air
- Quickly removable SuperCorona ring
- Powder tube coupling with quick-release fastener
- Covered hose and cable duct
- Simple conversion to a quick color change gun
- Easily dismantlable by a few hand movements, therefore very easy to service
- Few wearing parts (nozzle and SuperCorona)
- Easily removable cascade because free of grease, with integrated current limiting resistors

### Powder hose quick release connection

- Quick and simple connection and disconnection from powder hose and application cup



### Connection for SuperCorona Ring

- Quick and simple connection to and disconnection from the SuperCorona ring





# Start-up

---

## Preparation for start-up

### Basic conditions

When starting up the OptiGun GA03 Automatic powder gun, the following general conditions impacting the coating results must be taken into consideration:

- Gun correctly connected
- Gun control unit correctly connected
- Corresponding power and compressed air supply available
- Powder preparation and powder quality

---

## Connect the OptiGun automatic powder gun

The OptiGun GA03 Automatic powder gun is delivered ready-to-use by the manufacturer. Just a few cables and hoses must be connected.



---

### NOTE

The compressed air must be free of oil and water!

---

The gun is connected as follows:

1. Connect electrode rinsing air hose and powder hose to gun
2. Lay out gun cable, electrode rinsing air hose and powder hose and bind using Velcro strips (included)
3. Connect the gun cable plug to the socket **2.3** on the rear side of the control unit
4. Connect electrode rinsing air hose to coupling **1.4**
5. Connect powder hose to injector
6. Connect the gun plug to the gun control unit (see therefore the operating manual of the gun control unit)
7. Connect the electrode rinsing air hose of the control unit to the gun
8. Connect the powder hose from the gun to the injector

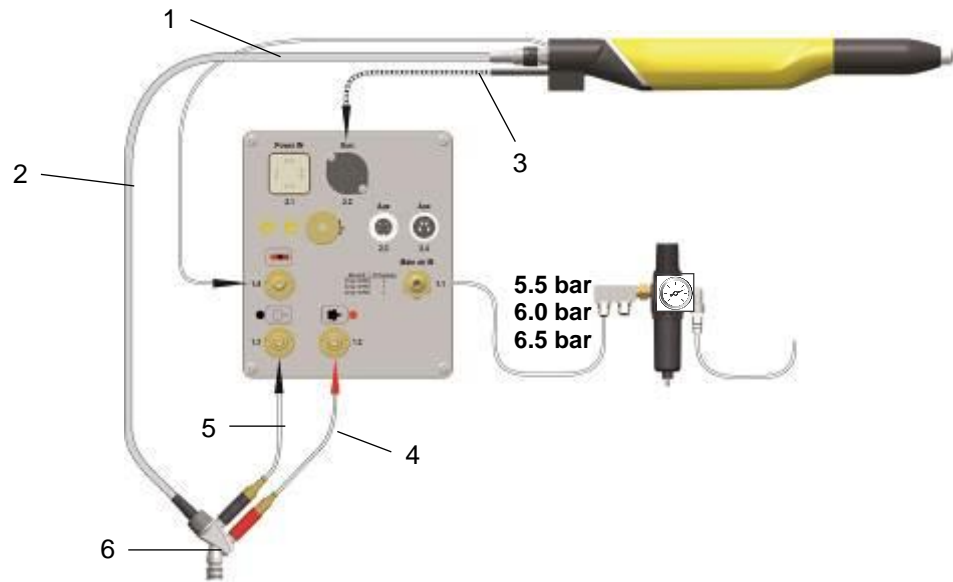

fig. 7: Connecting guide – overview

- |   |                            |   |                        |
|---|----------------------------|---|------------------------|
| 1 | Electrode rinsing air hose | 4 | Supplementary air hose |
| 2 | Powder hose                | 5 | Conveying air hose     |
| 3 | Gun cable                  | 6 | Injector               |

# Initial start-up



## NOTE

If a malfunction occurs, see the troubleshooting guide, as well as the gun control unit operating manual!

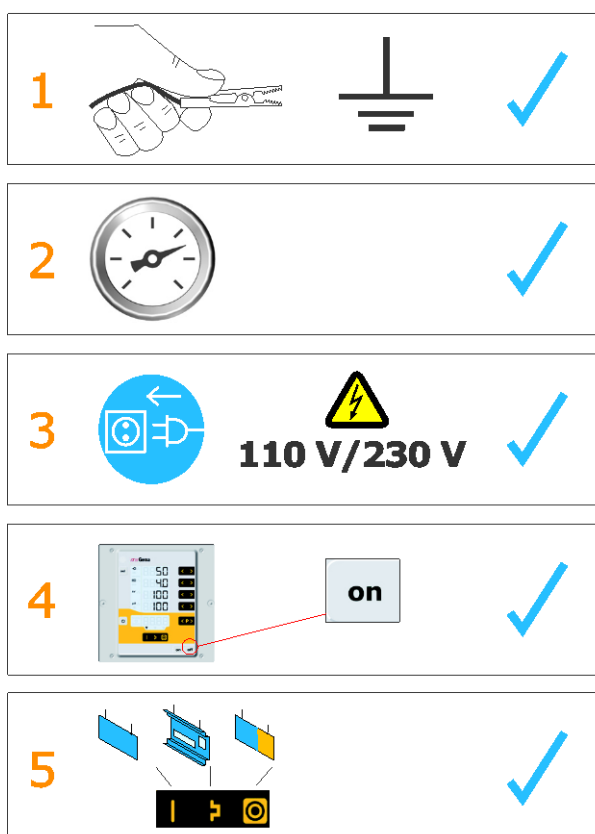

fig. 8:



## NOTE

The remainder of the start-up procedure for the OptiGun GA03 gun is explicitly described in the operating instructions for the OptiStar gun control unit (chapter "Initial start-up" and "Daily start-up")!

## Operation

### ⚠ WARNING

#### Touching the gun parts

During the coating process, the gun can discharge along the body of the coater if touching it.

- Do not touch any parts of the gun!

### Setting of total air



*correct powder cloud*



*too little total air*

### ▶ NOTE

A total air volume of 4 Nm<sup>3</sup>/h and a 50% powder share are recommended as the base values.

The total air volume is depending on the powder hose length, the number of hose curvatures, the hose diameter, the conveying air pressure and the supplementary air. The operation mode of the injector and the effect of the supplementary air are described in the corresponding injector operating instructions.

### ▶ NOTE

The adjusted value of the total air volume can be left as it is, as long as the same diameter powder hose is used. If the hose diameter changes, the total air volume must be reset.

## Setting the powder quantity

The powder output volume is selected in reference to the desired layer thickness. The selection is done on the control unit. For the beginning, the standard adjustment of 60% is recommended. The total air volume is thereby kept constant automatically.



### NOTE

The powder output depends on the powder type and the adjusted total air volume (see therefore the control unit operating manual)!



*much powder*



*little powder*



### NOTE

To achieve maximum efficiency, we recommend avoided an overly high powder volume where possible!

## Setting the electrode rinsing air

1. Select the correct electrode rinsing

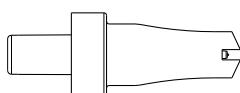

≈ 0.1 Nm<sup>3</sup>/h

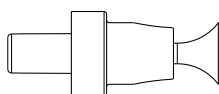

≈ 0.5 Nm<sup>3</sup>/h

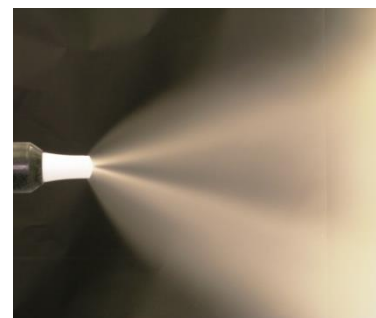

*too much electrode rinsing air*

2. Adjust the powder cloud with a test object

**If flat jet nozzles are used:**

1. Unscrew the threaded sleeve approx. 45°, so that the flat jet nozzle (or its extension) can be moved slightly
2. Turn the flat jet nozzle to desired axis direction
3. Tighten the threaded sleeve firmly again

**ATTENTION****Threaded sleeve not tightened well**

**If the spray nozzle is just fitted loosely, there is danger of a flash-over of the gun high voltage, which can damage the gun!**

- Always tighten the threaded sleeve well!

**If round jet nozzles with air rinsed deflectors are used:**

4. Replace the deflector (Ø 16, 24 and 32 mm are supplied with the gun)

---

## Functional check

### General information

1. The installed gun must be pointed towards a grounded work piece in the coating booth. All connections must be attached!
2. Turn on the gun control unit (see also the control unit operating instructions) - the gun starts spraying
3. Adjust the desired coating parameters (powder volume, total air and high voltage) on the gun control unit (see also the control unit operating instructions)
4. Adjust the electrode rinsing air on the control unit dependent upon the nozzle used

If all tests have been completed positively, the gun is ready for operation. If malfunctions take place, the cause of the fault can be located by the corresponding troubleshooting guide.

### Troubleshooting

If a malfunction occurs, see section "Troubleshooting". Please consider also the control unit operating instructions.

---

## Start-up and powder coating

### WARNING

**Dangerous discharges.**

**If not grounded parts within 5 m of the coating booth are sufficient charged, this can cause dangerous discharges.**

- All electrically conductive parts within 5 m of the coating booth must be grounded!

- 
1. Check the powder fluidization
  2. The installed gun must be pointed towards a grounded work piece in the coating booth
  3. Switch on the gun control unit
  4. Adjust the coating parameters or select one of the programs. Check by observing the LED displays
  5. The workpieces can be coated now

---

## Shut-down

1. Switch off the powder gun control unit. The adjustments for high voltage, powder output volume and electrode rinsing air remain stored.
2. If working interruptions take place, such as lunch time, night time etc. disconnect the main compressed air supply





# Cleaning and maintenance

---

## General information

### ATTENTION

All unauthorized modifications to the gun are forbidden for safety reasons, and exempt the manufacturer from any liability from resulting damage!



### NOTE

Regular, careful cleaning and maintenance extends the service life of the gun and ensures long-lasting, uniform coating quality!

- The parts to be replaced during maintenance work are available as spare parts. These parts can be found in the corresponding spare parts list!

---

## Cleaning

### Gun cleaning

#### ATTENTION

The following solvents may not be used to clean the gun:

- Ethylene chloride, acetone, ethyl acetate, methyl ethyl ketone, methylene chloride, premium gasoline, turpentine, tetrachloromethane, toluene, trichloroethylene, xylene!



#### NOTE

Only cleaning agents with a flash point of a least 5 Kelvin above the ambient temperature, or cleaning places with technical ventilation are allowed!



#### NOTE

Before cleaning the powder gun, switch off the control unit. The compressed air used for cleaning must be free of oil and water!

### *Daily*

1. Blow off the outside of the gun and wipe, clean etc.

**Weekly**

2. Remove powder hose
3. Remove the spray nozzle from the gun and clean it with compressed air
4. Blow through the gun with compressed air, beginning from the connection in flow direction
5. Clean the integrated gun tube with the brush supplied, if necessary
6. Blow through the gun with compressed air again
7. Clean the powder hose
8. Reassemble the gun and connect it

**Cleaning the spray nozzle****Daily or after every shift**

- Clean the inside and outside of the spray nozzle with compressed air.  
Never immerse the parts in solvents!
- Check the seating of the spray nozzles.

**ATTENTION****Threaded sleeve not tightened well**

**If the spray nozzle is just fitted loosely, there is danger of a flash-over of the gun high voltage, which can damage the gun!**

- Always tighten the threaded sleeve well!

**Weekly:**

- Remove the spray nozzle and clean on the inside with compressed air. If sinterings should have formed, then they have to be removed!

**Monthly**

- Check spray nozzle for wear

The flat jet nozzle is to be replaced, if:

- the spray pattern is no longer a regular oval
- deeper grooves are in the nozzle slot, or even the wall thickness is no longer recognizable
- the wedge of the electrode holder is worn

Nozzles with deflectors:

- if the wedge of the electrode holder is worn down, then the electrode holder is to be replaced

**Maintenance**

The gun is designed to require only a minimum amount of maintenance.

1. Clean the gun with dry cloth, see chapter "Maintenance"
2. Check connection points to powder house.

3. Replace the powder hoses, if necessary.

## Replacing parts

Except for the replacement of possible defective parts, there are very few repairs to be made.



---

### NOTE

The replacement of the cascade and the repair of the powder gun cable connection is only permitted by an authorized Gema Service center!

- Contact your Gema representative for details!
- 

---

## Dismantling the gun

### General information



---

### NOTE

The gun should only be dismantled, if this is required because of a defect or pollution.

- Dismantle the gun only so far, as the desired part is accessible!
- 

### WARNING

#### Touching the gun parts

**During work on the gun, the gun can discharge along the body of the coater if touching it.**

- Before dismantling the gun, switch off the control unit and disconnect the gun plug!
-

### Dismantling procedure

1.



2.



3.



4.



5.



6.



7.



8.



9.



10.



11.



12.





17.



18.



19.



20.

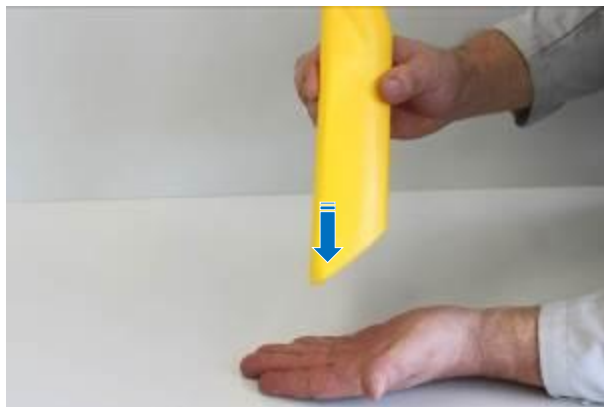



21.



22.

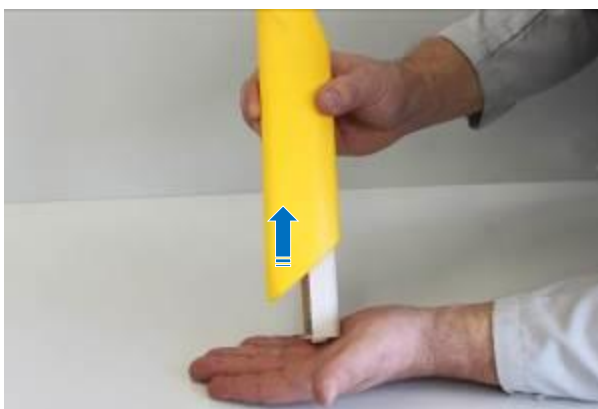

---

## Assembling the powder gun

The assembling of the automatic gun is to be carried out in the reverse order to that shown above.

---

## Repairing the powder gun

Apart from the replacement of possibly defective parts, hardly any repairs have to be made. The cascade can be replaced trouble-free. The repair of the gun cable connection, however, may only be made by an authorized Gema Service center.

Contact your Gema representative for details!

## Powder hose quick release connection

The hose connection should be left on the powder hose, for as long as this is used, that means, if two sets of powder hoses are available, the double number of hose connections will be required.

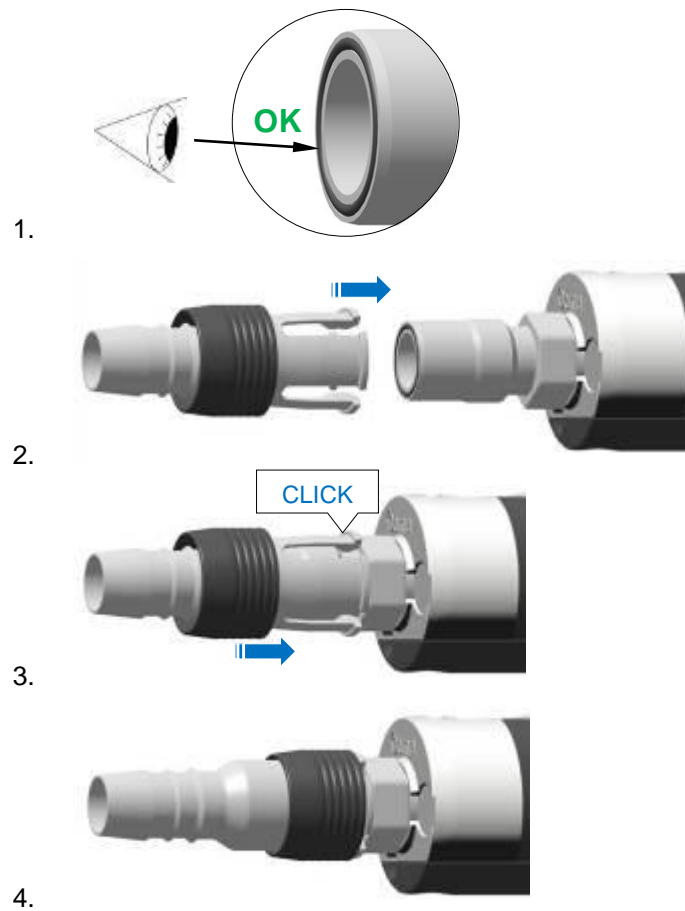

fig. 9: Powder hose quick release connection – Assembly

# Troubleshooting



## NOTE

Additional error descriptions are to be found also in the control unit operating instructions!

Fault	Causes	Corrective action
<b>H11 (Help code on control unit)</b>	Gun not connected	Connect the gun
	Gun plug or gun cable defective	Contact local Gema representative
	Remote control on powder gun defective	Contact local Gema representative
<b>The powder gun does not spray powder, although the powder gun control unit is switched on</b>	Compressed air not present	Connect the equipment to the compressed air
	Injector, check valve or throttle on injector, powder hose or powder gun clogged	Clean or replace the corresponding part
	Insert sleeve in injector is worn	Replace
	Insert sleeve in the injector is clogged	Clean/replace
	Pressure valve in the control unit defective	Replace
	Solenoid valve in the control unit defective	Replace
	Electronic board in the control unit defective	Contact local Gema representative
	No conveying air: - Throttle motor defective - Solenoid valve defective	Contact local Gema representative

Fault	Causes	Corrective action
<b>Powder gun sprays powder, but the powder does not adhere to work-piece</b>	High voltage and current deactivated or too low	Check the high voltage and current setting
	Gun cable (gun plug or gun connection) defective	Test the gun cable on another control unit
	High voltage cascade defective	Contact local Gema representative
	Electronic board in the OptiTronic defective	Send in for repair
<b>Powder gun sprays powder, high voltage is available, powder does not adhere to work-piece</b>	The objects are not properly grounded	Check the grounding
<b>Gun achieving only poor spray profile</b>	Total air incorrectly configured	Increase the powder quantity and/or total air volume on the control unit
	Bend or damage to air lines to injector	Check air lines to injector
	Insert sleeve in the injector worn or not inserted	Replace or insert it
	Fluidization not running	see above

# Spare parts list

---

## Ordering spare parts

When ordering spare parts for powder coating equipment, please indicate the following specifications:

- Type and serial number of your powder coating equipment
- Order number, quantity and description of each spare part

**Example:**

- **Type** OptiGun GA03 automatic powder gun,  
**Serial number** 1234 5678
- **Order no.** 203 386, 1 piece, Clamp – Ø 18/15 mm

When ordering cable or hose material, the required length must also be given. The spare part numbers of this bulk stock is always marked with an \*.

The wearing parts are always marked with a #. markiert.

All dimensions of plastic hoses are specified with the external and internal diameter:

**Example:**

Ø 8/6 mm, 8 mm outside diameter (o/d) / 6 mm inside diameter (i/d)

### ATTENTION

#### Use of non-original Gema spare parts

When using the spare parts from other manufacturers the explosion protection is no longer guaranteed. **If any damage is caused by this use all guarantee claims become invalid!**

- Only original Gema spare parts should be used!
-

## OptiGun GA03 – complete



### NOTE

**Only parts were included in the spare parts list, which the user can replace himself without problems!**

- If the powder gun cable (4) is defective, it is to be completely sent in for repair!

	OptiGun GA03 Automatic powder gun – complete, polarity negative, incl. pos. 1-10	1010 198
	OptiGun GA03 Automatic powder gun – complete, polarity positive, incl. pos. 1-10	1010 199
1	Powder gun body OptiGun GA03 – complete, polarity negative	1008 726
	Powder gun body OptiGun GA03 – complete, polarity positive	1008 727
2	Threaded sleeve – see "Nozzle combinations" spare parts list	
3	Flat jet nozzle – complete, see "Nozzle combinations" spare parts list	
	Gun cable pack, complete – incl. pos. 4 and 5	
	Gun cable pack 20 m	1010 222
	Gun cable pack 30 m	1010 223
4	Gun cable complete – see "Gun cable" spare parts list	
5	Electrode rinsing air hose – Ø 6/4 mm	103 144*
	Parts kit (pos. 6-9)	
6	Cylinder screw – M8x50 mm	235 113
7	Washer – Ø 8.4/20x2 mm	215 880
8	Quick release connection – NW5, Ø 6 mm, for pos. 5	200 840
9	Cable tie with Velcro closure (8x) (not shown)	303 070
10	Cleaning brush – Ø 12 mm (not shown)	389 765
11	Powder hose – Ø 16/11 mm (not shown)	105 139*#
12	Gun fixture	1008 711

\* Please indicate length

# Wearing part

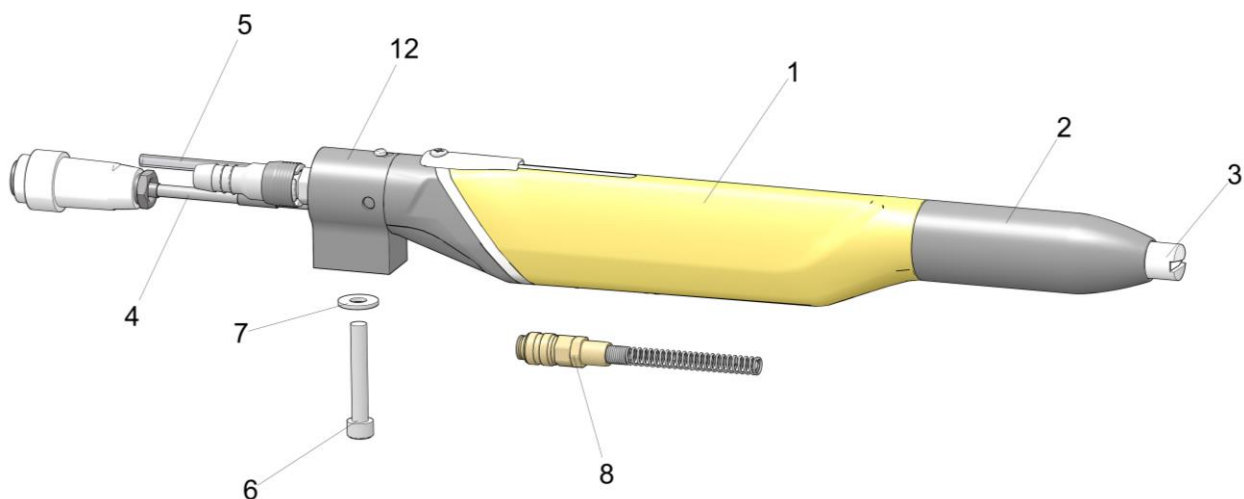

fig. 10: OptiGun GA03 – complete

## OptiGun GA03 – gun body

1	OptiGun GA03 shaft – complete, negative polarity (see spare parts list "Shaft")	
	Powder tube – complete (incl. pos. 2-5)	1008 644#
2	Powder tube	1008 641#
3	O-ring – Ø 12x1 mm, FPM75	1006 324#
4	Hose holder	1008 642#
5	Clamp ring	1008 643
6	Ground plate	1011 457
7	SuperCorona connection	1009 764
8	Cylinder screw – M5x6 mm	263 907

# Wearing part

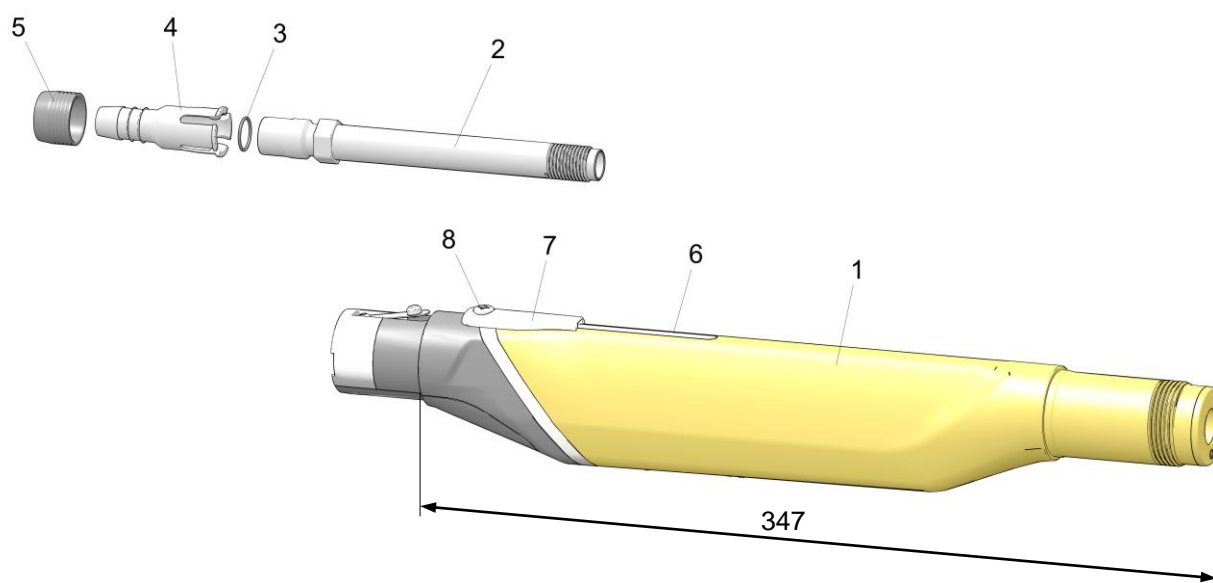

fig. 11: OptiGun GA03 – gun body

## OptiGun GA03 – shaft

	Shaft OptiGun GA03 – complete, polarity negative, incl. pos. 1-9	1008 681
	Shaft OptiGun GA03 – complete, polarity positive, incl. pos. 1.1-9	1008 682
1	Cascade – complete, negative polarity	1007 231
1.1	Cascade – complete, positive polarity	1007 232
2	Shaft (without cascade)	1008 675
3	Sealing piece – complete (incl. pos. 6)	1008 690
4	Axial gasket	1008 687
5	Threaded bolt	1009 587
6	O-ring – Ø 4x1.5 mm	264 466
7	Gun rear end – complete (incl. pos. 10-13)	1008 701
8	Lock knob	382 833
9	Screw – M3x3 mm	266 795
10	Screw-in nipple – M7-Ø 6 mm	1020 731
11	Rear end cover	1008 697
12	Countersunk head screw – M4x6 mm	214 639

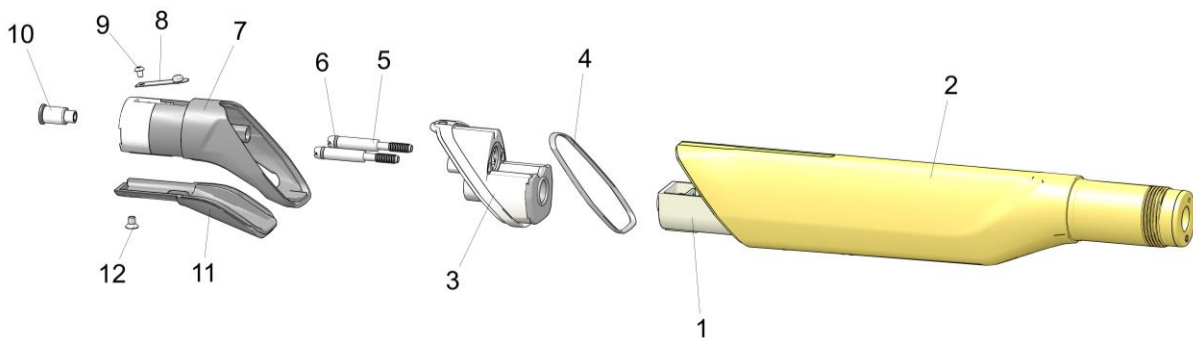

fig. 12: OptiGun GA03 – shaft



## OptiGun GA03-X – complete

	OptiGun GA03-X – Automatic powder gun – complete, polarity negative, incl. pos. 1-8	1010 198
	OptiGun GA03-X – Automatic powder gun – complete, polarity positive, incl. pos. 1-8	1010 199
1	OptiGun GA03-X gun body – complete, polarity negative	1008 726
	OptiGun GA03-X gun body – complete, polarity positive	1008 727
2	Threaded sleeve – see "Nozzle combinations" spare parts list	
3	Flat jet nozzle – complete, see "Nozzle combinations" spare parts list	
	Gun cable pack, complete – incl. pos. 4 and 5	
	Gun cable pack 20 m	1010 222
	Gun cable pack 30 m	1010 223
4	Gun cable – complete, see "Gun cable" spare parts list	
5	Electrode rinsing air hose – Ø 6/4 mm	103 144*
	Parts kit (pos. 6-7)	
6	Quick release connection – NW5, Ø 6 mm, for pos. 5	200 840
7	Cable tie with Velcro closure (8x) (not shown)	303 070
8	Cleaning brush – Ø 12 mm (not shown)	389 765
9	Powder hose – Ø 16/11 mm (not shown)	105 139*
10	Extension tube – see "OptiGun GA02-X-Extension tube" spare parts list	

\* Please indicate length

# Wearing part

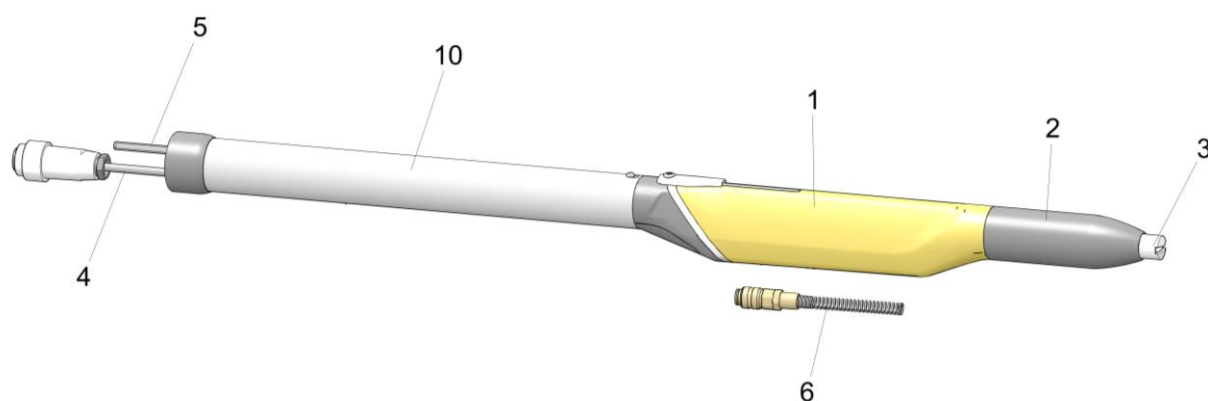

fig. 13: OptiGun GA03-X – complete

## OptiGun GA03-X – Extension tube

Extension tube for:		
	OptiGun GA03-700, L=711 mm	1025 312
	OptiGun GA03-900, L=911 mm	1025 313
	OptiGun GA03-1100, L=1111 mm	1025 314
	OptiGun GA03-1300, L=1311 mm	1025 315
	OptiGun GA03-1500, L=1511 mm	1025 316
	OptiGun GA03-1700, L=1711 mm	1025 317
	OptiGun GA03-1900, L=1911 mm	1025 318
	OptiGun GA03-2100, L=2111 mm	1025 319
1	End piece - complete (incl. O-rings)	1008 724

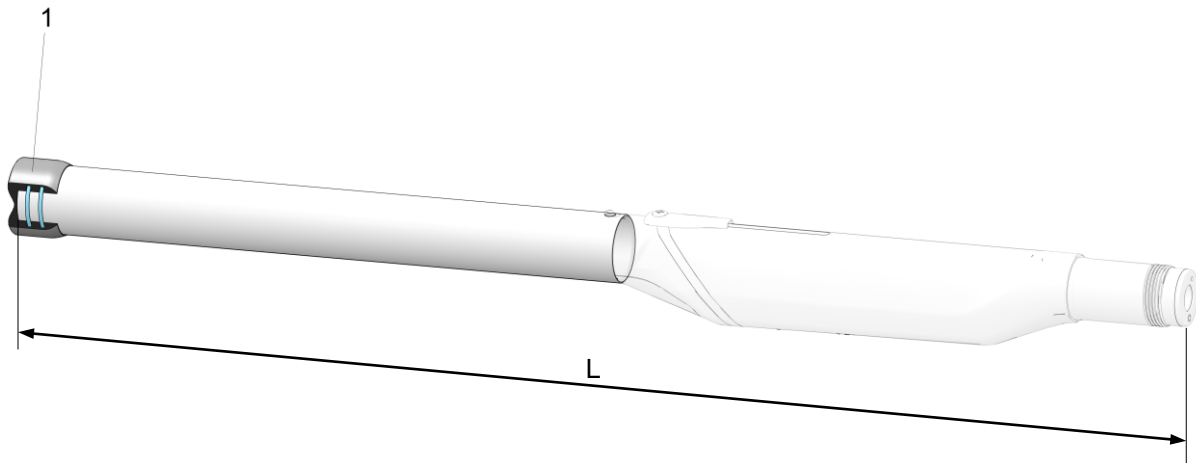

fig. 14: OptiGun GA03-X – Extension tube

## OptiGun GA03-X – options when using several powder hoses

1	Powder tube extension for:	
	OptiGun GA03-700	1009 557#
	OptiGun GA03-900	1009 558#
	OptiGun GA03-1100	1009 559#
	OptiGun GA03-1300	1009 560#
	OptiGun GA03-1500	1009 561#
	OptiGun GA03-1700	1009 562#
	OptiGun GA03-1900	1009 563#
	OptiGun GA03-2100	1009 564#
2	Clamp ring	1008 643

# Wearing part

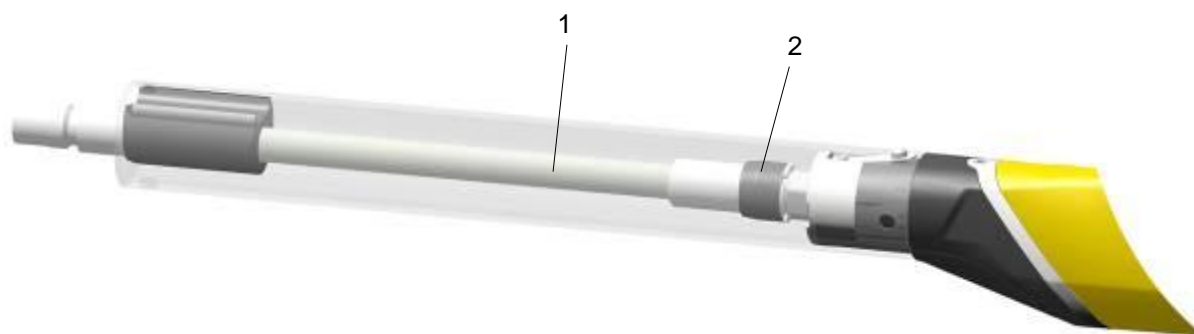

fig. 15: OptiGun GA03-X – options when using several powder hoses

## Gun cable



### NOTE

If the powder gun cable is defective, it is to be completely sent in for repair!

	Gun cable – complete, 11 m	1008 661
	Gun cable – complete, 15 m	1008 662
	Gun cable – complete, 20 m	1008 663
	Gun cable – complete, 30 m	1008 664
1	Cylinder screw – M4x6 mm	1008 639
2	O-ring – Ø 9.5x1.5 mm	1025 166
3	O-ring – Ø 8.5x1 mm	1025 325

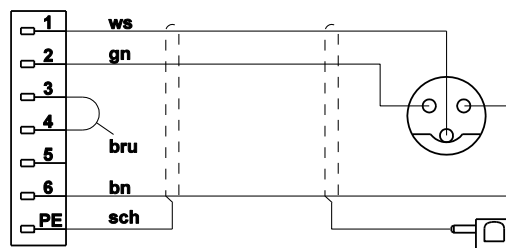
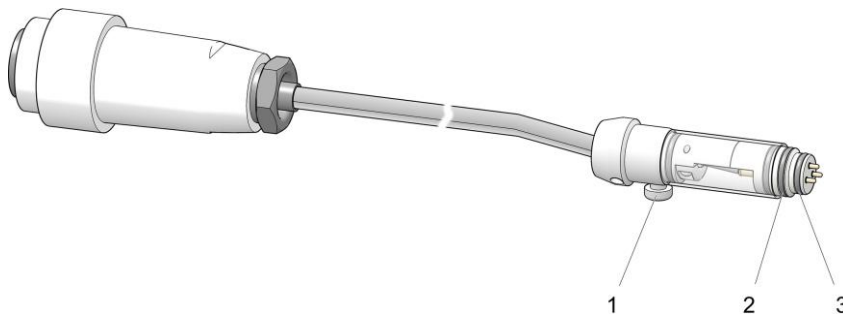

Pin allocation	
ws	white
gn	green
bru	Bridge
bn	brown
sch	Shield

fig. 16: Gun cable (complete)

---

## OptiGun GA03 – SuperCorona

---

1	SuperCorona ring – complete	1009 761#
---	-----------------------------	-----------

# Wearing part

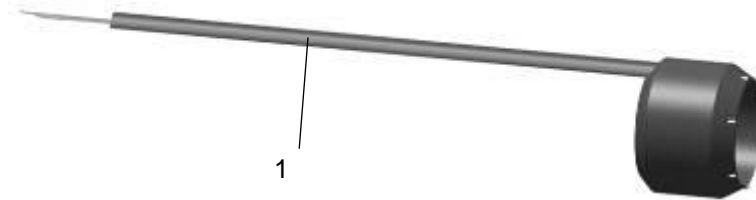

*fig. 17: OptiGun GA03 – SuperCorona*

## OptiGun GA03 – angled nozzles

<b>A</b>	Angled body PA03-90° – complete (without pos. 4.1)	1009 139#
<b>B</b>	Angled body PA03-60° – complete (without pos. 4.1)	1009 138#
<b>C</b>	Angled body PA03-45° – complete (without pos. 4.1)	1009 137#
<b>D</b>	Extension PE09-090 – complete	1010 931#
	Extension PE09-120 – complete	1010 932#
	Extension PE09-180 – complete	1010 933#
<b>1</b>	PA03-90° knee piece – complete	1009 135#
<b>2</b>	PA03-60° knee piece – complete	1009 134#
<b>3</b>	PA03-45° knee piece – complete	1009 133#
<b>4</b>	Threaded sleeve	1009 128
<b>4.1</b>	Threaded sleeve for NF24 Flat jet nozzle	1012 654
<b>5</b>	Nozzle – see "OptiGun GA03 – accessories"	

# Wearing part

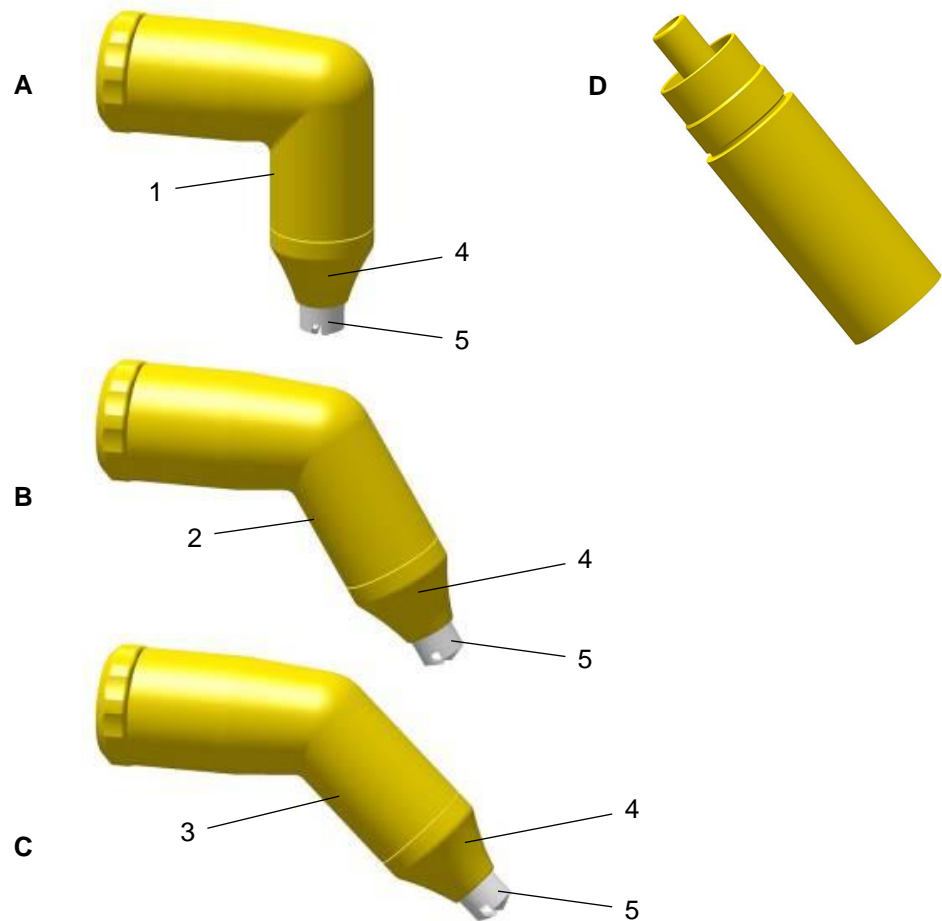









fig. 18: OptiGun GA03 – angled nozzles



## OptiGun GA03 – accessories

### Flat jet nozzles – overview (wearing parts)

Application	A	B	A + B	Threaded sleeve
Profiles/flat parts (standard nozzle)	 NF27 1010 752		<b>NF27</b> 1010 754	
Profiles/flat parts	 NF20 1010 090	 1007 683	<b>NF20</b> 1007 931	 1007 229
Complex profiles and depressions	 NF21 1007 935		<b>NF21</b> 1007 932	
Large surfaces	 NF24* 1008 147		<b>NF24</b> 1008 142	 1008 326

\* not suitable for angled nozzles

### Round jet nozzles – overview (wearing parts)

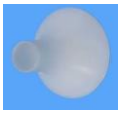
Application	A	B	A + B	Threaded sleeve	Deflectors
Suitable for large surfaces	 NS04 1008 151	 1008 152	<b>NS04</b> 1008 150	 1007 229	 Ø 16 mm 331 341
					Ø 24 mm 331 333
					Ø 32 mm 331 325
					Ø 50 mm 345 822

### Round jet nozzle NS12-11





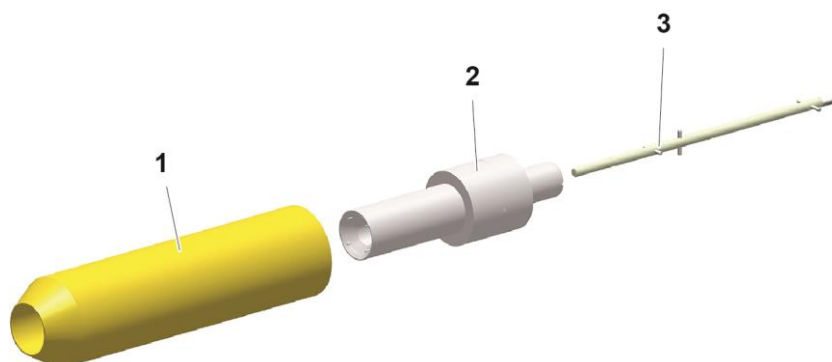



Round jet nozzle with 4 electrodes NS12-11 – complete, pos. 1, 2, 3	1010 922#
1 Threaded sleeve – complete	405 736
2 Muzzle NS12-11 – complete	1010 925#
3 Deflector rod – complete	1000 346#
4 Deflector – Ø 12 mm (not shown)	301 175#
4.1 Deflector – Ø 16 mm (not shown)	302 040#
4.2 Deflector – Ø 20 mm (not shown)	301 183#
4.3 Deflector – Ø 24 mm (not shown)	301 191#
4.1 Deflector – Ø 28 mm (not shown)	302 031#
4.4 Deflector – Ø 32 mm (not shown)	301 205#
4.5 Deflector – Ø 50 mm (not shown)	302 023#

# Wearing part





## Gun extensions

Gun extensions		
	L = 150 mm	L = 300 mm
without nozzle <sup>1</sup>	 1008 616	 1008 617
without nozzle <sup>2</sup>	 1007 718	 1007 719
with Flat jet nozzle NF25	 1007 746	 1007 747
with Round jet nozzle NS09	 1007 748	 1007 749

<sup>1</sup> see NF27, NF20, NF21, NF24, NS04

<sup>2</sup> see NF25, NF26, NS09

### ATTENTION

#### Connecting more than two extensions together

It is not permitted to connect more than two extensions together, in order to prevent the gun from being damaged by arising leverage force.

- The extensions (150 mm/300 mm) may be connected TO ONLY ONE ADDITIONAL extension (150 mm/300 mm), if necessary.





### Spray nozzles for extensions – overview (wearing parts)



1007 718

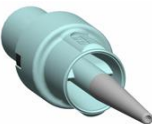

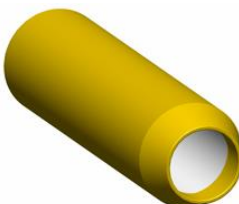
1007 719

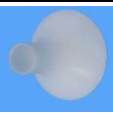
Application	A	B	A + B	Threaded sleeve	Deflectors
Profiles/flat parts	 NF25 1007 735	 1007 684	<b>NF25</b> 1007 743		--
Complex profiles and depressions	 NF26 1007 742		<b>NF26</b> 1007 744	 1007 740	--
Suitable for large surfaces	 NS09 1008 257	 1008 258	<b>NS09</b> 1008 259		 Ø 16 mm 331 341 Ø 24 mm 331 333 Ø 32 mm 331 325 Ø 50 mm 345 822

## Powder hoses – overview

Powder hose (antistatic)	Application	Diameter	Parts No.*	Material	Type
 <p>           Ø 12/ 18 mm Typ 75 Material POE         </p> <p>           Ø 11/ 16 mm Typ 66 Material POE         </p> <p>           Ø 10/ 15 mm Typ 74 Material POE         </p>	Fast color changes	Ø 11/16 mm	<b>105 139</b>	POE	<b>66</b>
	Fast color changes - low powder flow	Ø 10/15 mm	<b>1001 673</b>	POE	<b>74</b>
	Fast color changes - high powder flow	Ø 12/18 mm	<b>1001 674</b>	POE	<b>75</b>

\* Please indicate length

